



5 till 10
years



For weights
up to 35 kg



<->
120 to 175
mm



numeric
code lock
included



e-bike
fitting



no° 5
included

urban iki

イキ BY OGK

Scan for
instruction video



With adjustable
back rest



Junior seat Carrier mounting

Fietszitje achter dragermontage
キャリア取付けタイプ自転車用リヤシート



E-bike compatible

www.urbaniki.com

urban
iki
イキ BY OGG



Hi,

You have made an excellent choice in buying the Urban Iki Junior seat, the child bike seat for taking your child on the best bike rides.

Urban Iki by OGG has been developed by Dutch and Japanese designers and our products truly combine the best of both worlds. OGG has been producing innovative products for cycling consumers for eighty years and is the ultimate bike seat expert in the Netherlands, the world's ultimate bicycle country. Technology and safety at the highest level, Japanese know-how and world-renowned Dutch design are brought together in perfect harmony in your Urban Iki bike seat.

The Urban Iki Junior seat is easily attached to your bike rack. To this end and for the safety of both you and your child, your bicycle must be fitted with an ISO 11243 (EN 14872 for Europe) compliant luggage rack. There is a support bracket included which ensures that the weight of your child is also supported by your bicycle frame. The greatest load that can actually be carried is 35 kg.

Visit www.urbaniki.com for our complete range of products and all available accessories.

Box contents

- a For Urban Iki Junior seats with mounting frame
- b For Urban Iki Junior seats without mounting frame



a b Urban Iki Junior seat



a b Luggage rack mounting frame

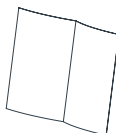

a b User manual



a b No. 5 socket head wrench



a b 2x junior footrests



a b Support bracket



a Support bracket holder

You can only fit an Urban Iki Junior seat without a luggage-rack mounting frame if you already have one in your possession. This mounting frame comes with an Urban Iki Rear seat for kids from 9 months to 6 years old.

User manual

The Urban Iki Junior seat is easy to assemble and attach to your bike. The user manual will explain step by step how to do this quickly and easily for you to be straight on your way and enjoy your bike ride together with your child. Please read the manual carefully before using the Urban Iki Junior seat and follow the instructions for safe use closely. This will ensure you have lots of safe cycling fun.



To avoid risk of suffocation, keep all plastic packaging materials out of reach of babies and children. Dispose of the packaging immediately.

What makes the Urban Iki Junior seat unique?

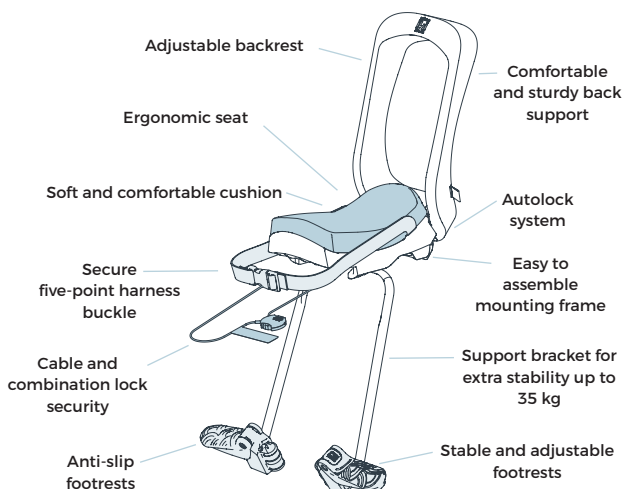

How to assemble your Urban Iki Junior seat

The bicycle seat can be mounted on a luggage carrier with a width between 120-175 mm. Please keep in mind that you can only use the Urban Iki Junior seat on bicycles that are suitable for the heavier loads.

Consult your bicycle manual or ask the manufacturer. If your bike is technically sound, you can mount your Urban Iki Junior seat as follows.

Please note: if you have already fitted a mounting frame on your luggage carrier for the use of an Urban Iki rear seat, remove it from the luggage carrier before you start fitting the Urban Iki Junior seat.



Scan for
instructional video

Step 1: Put the footrests up



Step 2: Remove the screws and the semicircular cover from the footrests



Step 3: Place the footrests around the rear wheel frame

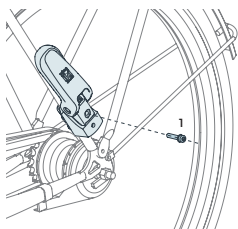
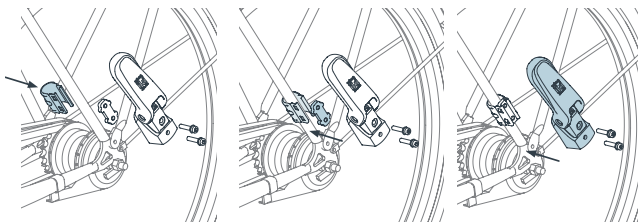

1. Do not fully tighten

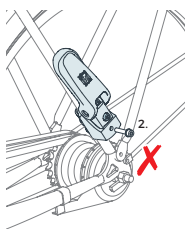

2. Do not yet install the lower screw due to the support bracket in step 4.

Step 4: Place the support bracket on the luggage carrier

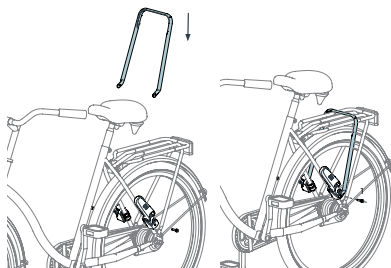

1. Do not fully tighten it yet

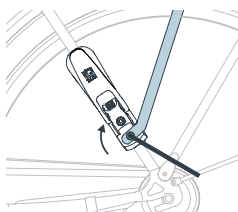

Step 5: Click the support bracket holder in the mounting frame

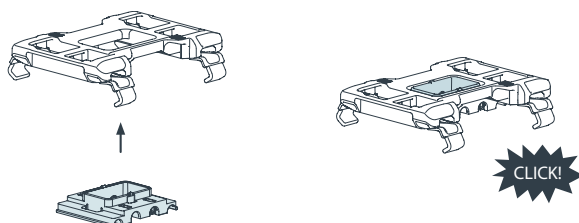

Step 6: Unscrew the mounting frame

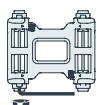

Step 7: Place the mounting frame on the luggage rack

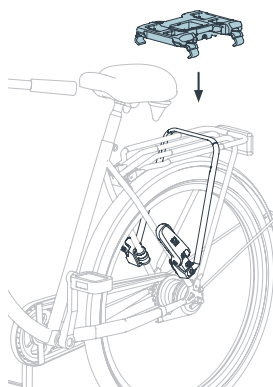

Step 8: Place the support bracket in one of the 2 middle recesses

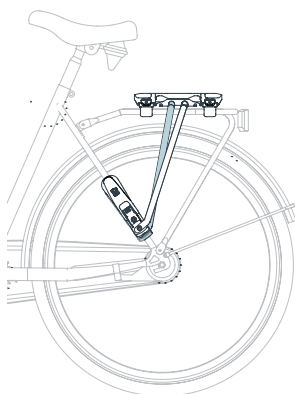

Step 9: Click the mounting frame incl. support bracket holder onto the support bracket

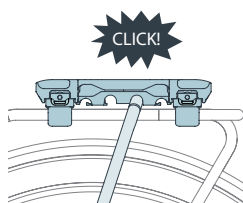

Step 10: Position the footrests and mounting frame

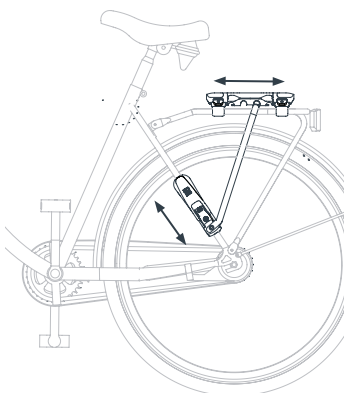

Step 11: Tighten the footrests and mounting frame

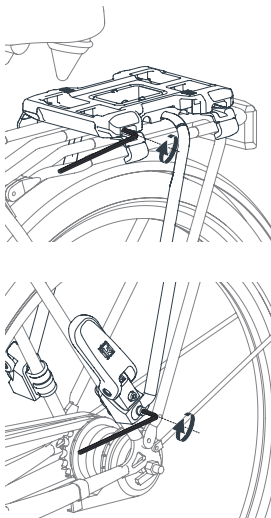

Step 12: Place the seat on the carrier

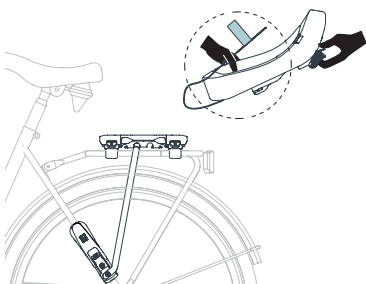

1. Hold the Junior seat and wire lock together

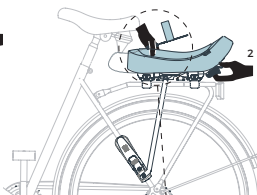
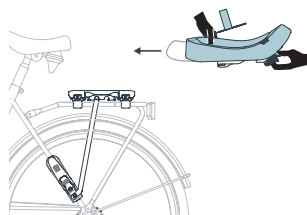
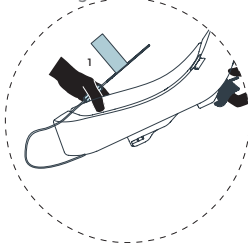

2. Slide the Junior seat in a horizontal position over the mounting frame

3. Apply pressure to the Junior seat
4. Place the front of the Junior seat in the mounting frame

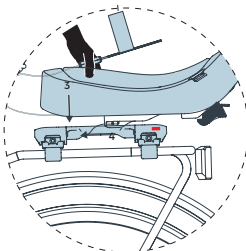

5. Press down the Junior seat

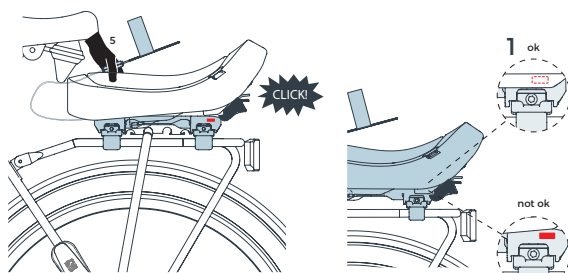

The seat is attached correctly if the red sticker on the side (1) and the handle (2) is no longer visible.

Always check to see if you have properly attached and locked the cable with combination lock around the frame when attaching the Junior seat.

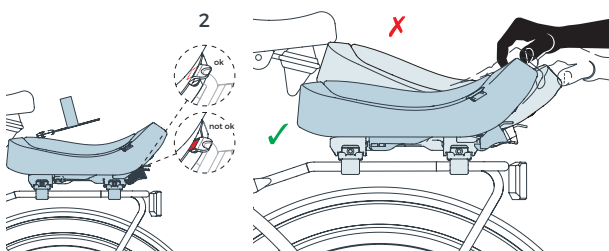

Step 13: Set personal code

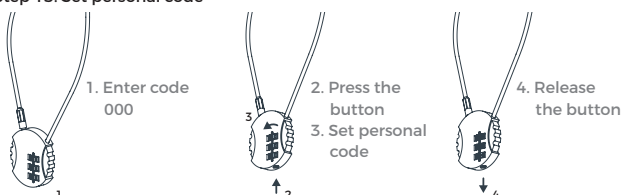

Step 14: Open the lock

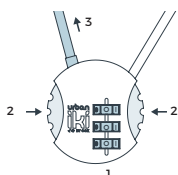

1. Enter the code
2. Press the two sides
3. Uncouple the cable

Step 16: Close the lock

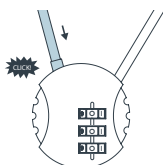

Step 15: Put the cable around the frame tube

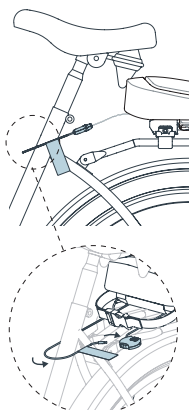

Demounting the Urban Iki Junior seat

Step 1: Open the lock

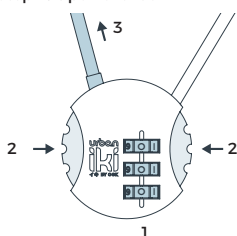

1. Enter the code
2. Press the two sides
3. Uncouple the cable



Scan for
instructional video

Step 2: Remove the cable

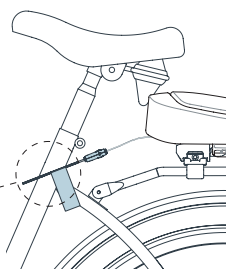
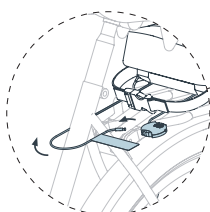

Step 3: Remove the Junior seat

1. Press the button
2. Pull out

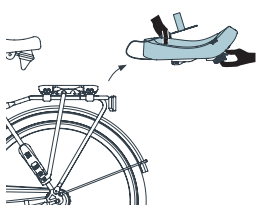
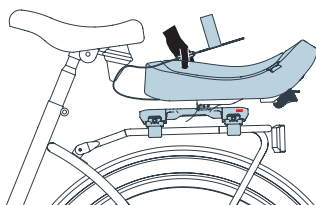
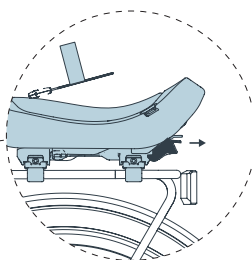
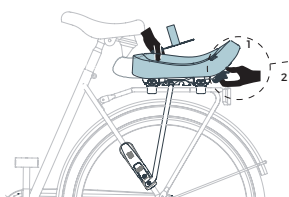

How to use the Urban Iki Junior seat

When using the Urban Iki Junior bicycle seat, check to see if it is attached correctly and do a short trial run without your child. If everything functions properly and you are not hindered when cycling, then you are ready to go cycling together with your child. Adjust the footrests to the correct height and raise the backrest so he/she sits firm and comfortably. Always make sure that no sharp bike parts are within reach of your child and make sure that he/she does not wear clothes that may come into contact with any moving or turning parts of your bike. You can use the safety belt to secure your child. This is located under the cushion of the seat. If you are not using the belt and/or the seat, click it together and let it hang at the front of the Junior seat above the luggage rack, or store the belt under the cushion. This way you prevent the belt from getting caught in the wheel while cycling.



Scan for
instructional video

Open and close the backrest

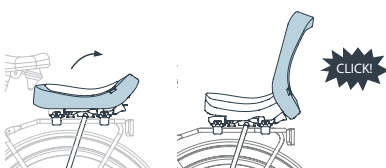

Open and close the safety belt

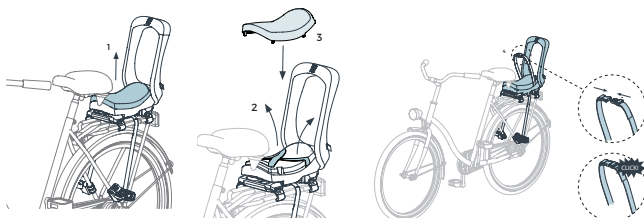

Store the safety belt

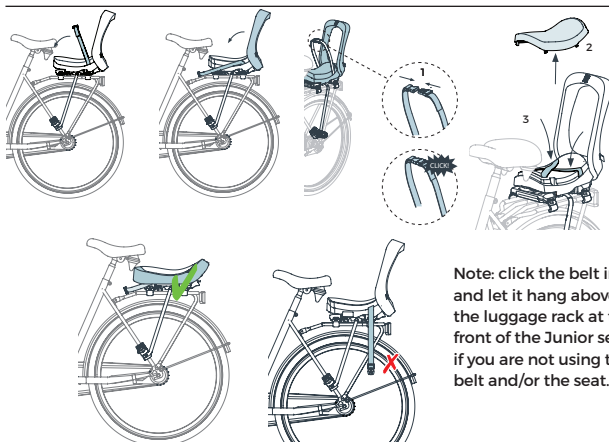

Note: click the belt in and let it hang above the luggage rack at the front of the Junior seat if you are not using the belt and/or the seat.

Safe use; a few warnings:

- Only take your child out on the Junior bicycle seat if he/she can sit upright independently and is able to place his/her feet on the footrests.
- Always make sure your child is wearing suitable clothes for the trip and is protected against the rain. Remember, your child sits motionless and will get cold quickly.
- Never leave your child on the bike seat by himself/herself without you holding the bicycle. Make sure your bike is equipped with a sturdy (double) kickstand.
- If you have a bike saddle with saddle springs, then cover these springs to avoid crushing and injuring your child's hands and fingers.
- Ensure the bike seat has not been exposed to the heat of the sun before placing your child on the seat.
- Never make custom adjustments to the bike seat and always contact the store where you bought the seat or Urban Iki's customer service in case of any defect. Do not use the bike seat if there is a defective part.
- Always remove the bike seat when transporting your bike on a car bicycle rack. Turbulence can damage or dislodge the seat, thus making it unsafe for use.
- Always lock the seat belt on the Junior seat, even when cycling without your child. This prevents the belt from getting caught on something. Click the belt together and let it hang at the front of the bicycle seat, over the luggage rack or store it under the seat cushion.
- Only use the bike seat for transporting a child on your bike. Bags or other luggage are best transported on the bike or attached to a position opposite that of your child, to equally distribute the weight on your bike.
- Do not lift your bicycle by the bicycle seat.
- Urban Iki recommends using a helmet that fits your child properly.
- Your Urban Iki Junior seat is intended for day-to-day transport of your child; it is not suitable for off-road and ATB tracks.
- Cycling with a child in a child bike seat can influence your bicycle's handling. This applies specially to cornering, braking and departing.
- You must be 16 or older to be allowed to transport a child in an Urban Iki bike seat. Corresponding legislation may differ depending on the country.

Maintenance, Warranty and Service

If you maintain your Urban Iki Junior seat well, it will last you a very long time. It is sufficient to clean the bike seat with a cloth, lukewarm water and a mild cleaning agent from time to time.

We issue a two-year warranty on your Urban Iki Junior seat. This warranty period enters into effect on the date of purchase as stated on the receipt. Store this receipt safely to be able to make use of this warranty.

Warranty is excluded in the following situation:

- Improper use of the product other than stated in the user manual.
- Not returning the product with the original receipt within the warranty period.
- Repairs performed on the Urban Iki bike seat by third parties.
- Any defect that is the result of improper, careless use or maintenance, negligence or accident.
- Normal wear and tear of components that is to be expected in the daily use of a product.

The warranty is issued in accordance with European Directive 99/44/EC of 25 May 1999.

In case of a complaint with or a defect to your Urban Iki bike seat, please feel free to contact the store where you bought your Urban Iki bike seat directly or contact our customer service.

Urban Iki customer service
OGK Europe B.V.
Energiestraat 13
7442 DA Nijverdal
The Netherlands

www.urbaniki.com
E: info@urbaniki.com



For you to discover

Osaka - Amsterdam